

CDM-DAMPING-SHEET

SYSTEM DATASHEET



Sound Isolation Layer Resilient Damping Mat



CDM-RC-15



CDM-RC-17

CDM-DAMPING-SHEET is typically made of CDM-RC recycled corkrubber elastomer material. This material introduces an impedance jump in the partition, reducing sound wave energy and transmitted sound. The effect of this layer is substantial for lower mass partitions (i.e. gypsum as compared to masonry). Thicker layers provide greater isolation. Typical thicknesses are 1/8" [3mm] or 3/16" [5mm].

High Performance:

CDM-RC-17

CDM-DAMPING-SHEET resilient sound isolation material is a thin layer of a resilient elastomer designed to increase sound isolation of partitions by 2-3 dB. This material is adhered between board layers during construction.

Benefits:

- 2-3 dB additional sound isolation
(vinyl barrier only adds 1dB isolation)
- Recycled corkrubber material
- Low added mass, minimal thickness
- Easy installation (new construction or renovation)
- Available in rolls or sheets

Medium Performance:

CDM-RC-15

Example Installation of CDM-DAMPING-SHEET

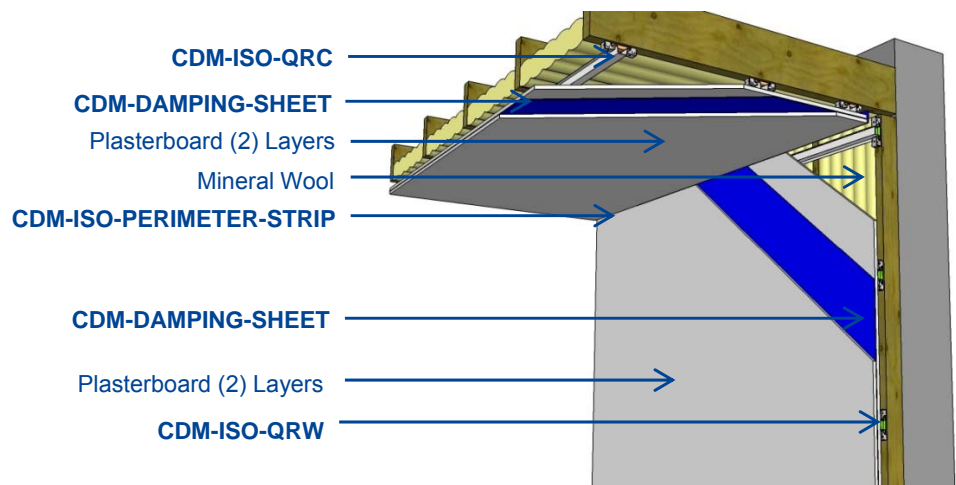

CDM-ISO-WALL

185

